

OH SYSTEMS**2.77.051.476.000****MOBEL LINEA**
MUEBLES OFICINA

MONTAJE LIBRERIA ALTA TRASERA DE 19 MM. ENRASADA - 19 MM. BACK PANEL CABINET ASSEMBLY
MONTAGE ARMOIRE FOND 19 MM. - MONTAGE SCHRANK MIT RÜCKSICHTWAND 19 MM.

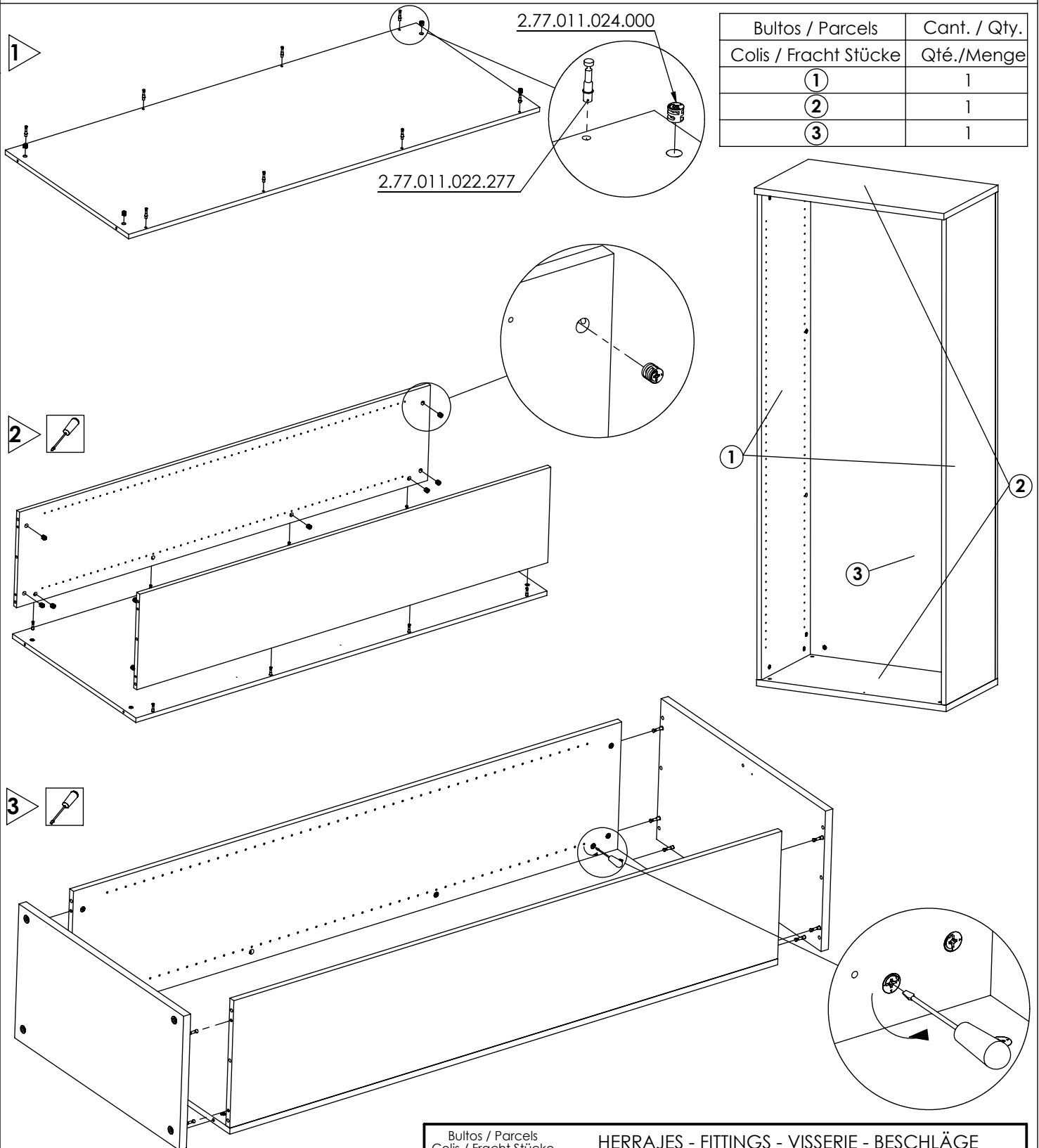

Bultos / Parcels	Cant. / Qty.
Colis / Fracht Stücke	Qté./Menge
①	1
②	1
③	1

Bultos / Parcels
Colis / Fracht Stücke

HERRAJES - FITTINGS - VISSERIE - BESCHLÄGE

Ref. 1.08.365.001.000 + 1.08.365.005.000			
Ref. 2.77.011.022.277	Ref. 2.77.011.024.000	Ref. 2.77.039.580.000	Ref. 2.77.039.581.000
①	②	③	④
20	20	24	3

OH SYSTEMS**MOBEL LINEA**
MUEBLES OFICINA

MONTAJE ESTANTES LIBRERÍAS - ASSEMBLY INSTRUCTIONS FOR BOOKCASE SHELVES
NOTICE DE MONTAGE DES ÉTAGÈRES - INNENEINRICHTUNG DER AKTENSCHRÄNKE

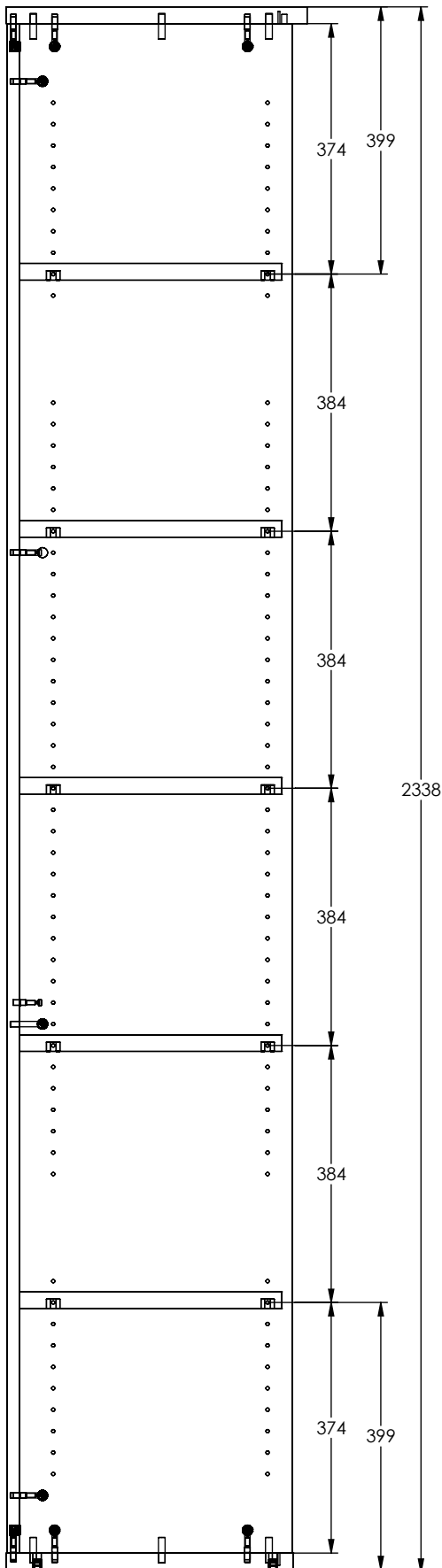

- Distribución óptima de estantes para carpesanos o archivadores (A-Z).
Medidas aplicables a todas las alturas.

- Shelf allocation for A-Z binders.
Dimensions are applicable to all heights.

- Distribution optimale des étagères pour les classeurs.
Mesures valables pour toutes les hauteurs.

- Optimale Inneneinrichtung der Fachböden für Mappen.
Geltende Masse für alle höhen der Schränke

- COLOCACIÓN PLANTILLA EN LATERAL
- PLACE THE TEMPLATE ON THE SIDE
- PLACER LE GABARIT SUR LE CÔTÉ
- LEGEN SIE DIE SCHABLONE ZUR SEITE

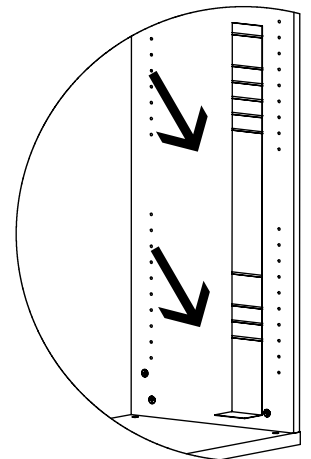
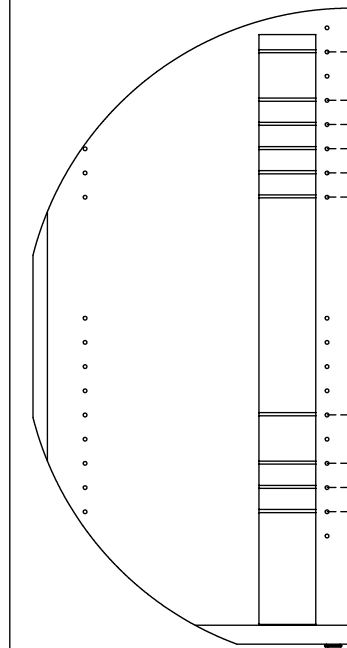

Puertas
Doors
Portes
Flügeltüren

◆ Archivo frontis
Telescopic drawer
Cadre des tiroirs
Hängeauszüge + Fronten

▲ Archivo puertas
Telescopic file
Cadre des portes
Hängerahmen

* Pivote cierre
Lock pin
Vis fermeture
Verriegelungsbolzen

+ Separador
Divider
Séparateur
Konstruktionsboden

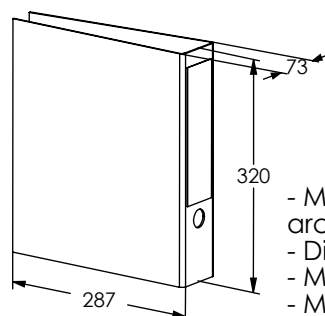

- Medidas carpesano o archivadores (A-Z)
- Dimensions for A-Z binders
- Mesures du classeur
- Masse der Mappen (A-Z)

OH SYSTEMS 2.77.051.476.001**MOBEL LINEA**
MUEBLES OFICINA

MONTAJE LIBRERIA BAJA TRASERA DE 19 MM. ENRASADA - 19 MM. BACK PANEL CABINET ASSEMBLY
MONTAGE ARMOIRE FOND 19 MM. - MONTAGE SCHRANK MIT RÜCKSICHTWAND 19 MM.

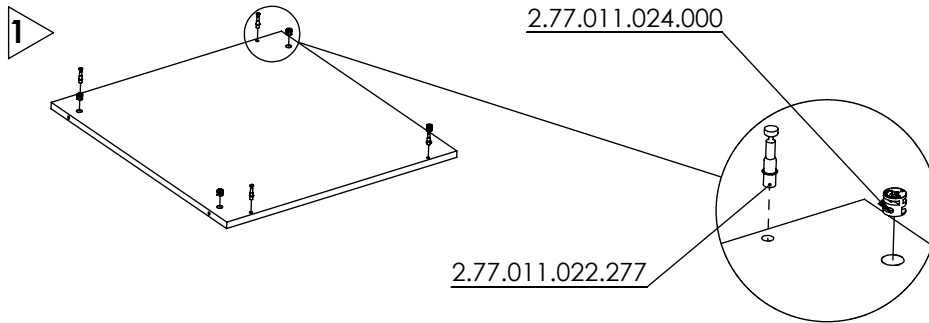

Bultos / Parcels	Cant. / Qty.
Colis / Fracht Stücke	Qté./Menge
①	1
②	1
③	1

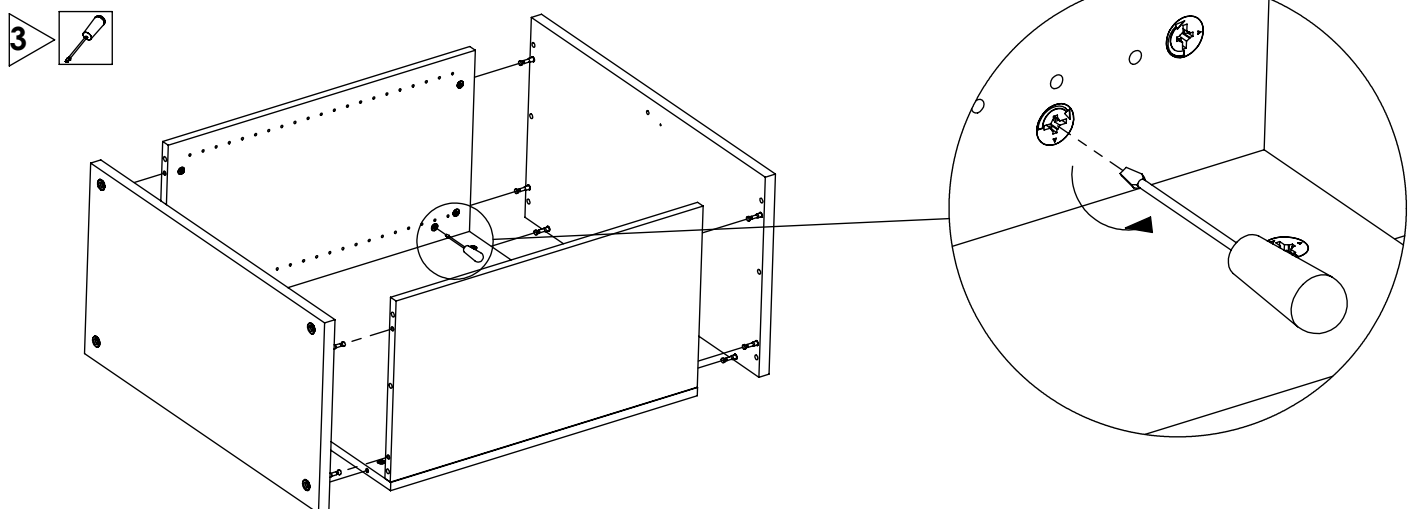
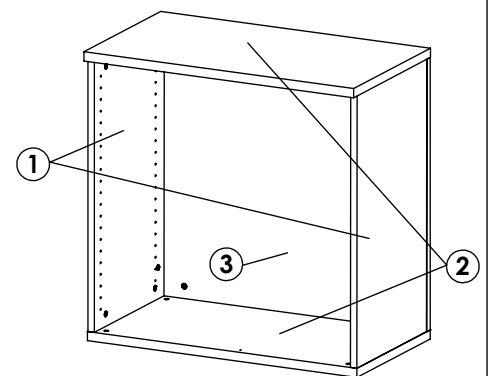
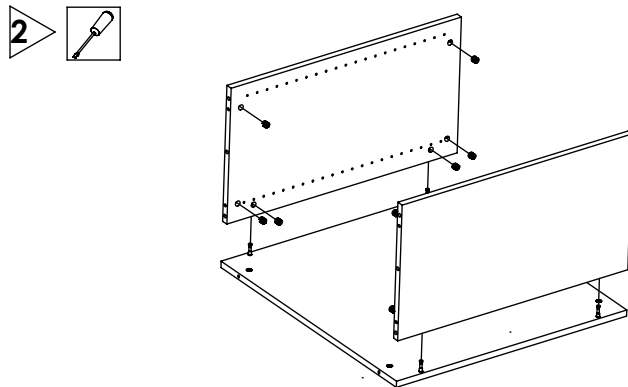

Bultos / Parcels
Colis / Fracht Stücke

HERRAJES - FITTINGS - VISSERIE - BESCHLÄGE

Ref. 1.08.365.001.000 + 1.08.365.006.000				
	Ref. 2.77.011.022.277	Ref. 2.77.011.024.000	Ref. 2.77.039.580.000	Ref. 2.77.039.581.000
①				
②				
	8 + 8	8 + 8	8 + 8	3

OH SYSTEMS**MOBEL LINEA**
MUEBLES OFICINA

MONTAJE ESTANTES LIBRERÍAS - ASSEMBLY INSTRUCTIONS FOR BOOKCASE SHELVES
NOTICE DE MONTAGE DES ÉTAGÈRES - INNENEINRICHTUNG DER AKTENSCHRÄNKE

- Distribución óptima de estantes para carpesanos o archivadores (A-Z).
Medidas aplicables a todas las alturas.

- Shelf allocation for A-Z binders.
Dimensions are applicable to all heights.

- Distribution optimale des étagères pour les classeurs.
Mesures valables pour toutes les hauteurs.

- Optimale Inneneinrichtung der Fachböden für Mappen.
Geltende Masse für alle höhen der Schränke

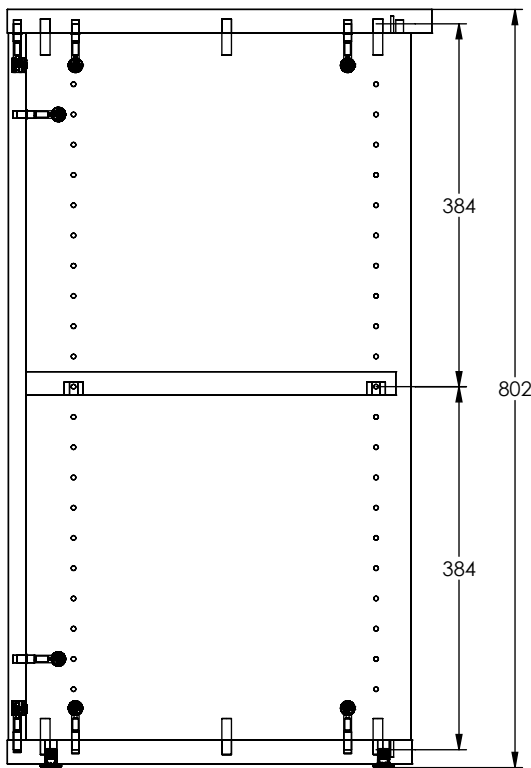

- COLOCACIÓN PLANTILLA EN LATERAL
- PLACE THE TEMPLATE ON THE SIDE
- PLACER LE GABARIT SUR LE CÔTÉ
- LEGEN SIE DIE SCHABLONE ZUR SEITE

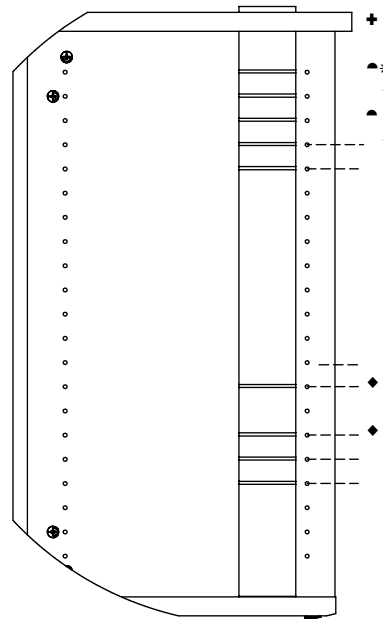

Puertas
Doors
Portes
Flügeltüren

◆ Archivo frontis
Telescopic drawer
Cadre des tiroirs
Hängeauszüge + Fronten

▲ Archivo puertas
Telescopic file
Cadre des portes
Hängerahmen

* Pivote cierre
Lock pin
Vis fermeture
Verriegelungsbolzen

+ Separador
Divider
Séparateur
Konstruktionsboden

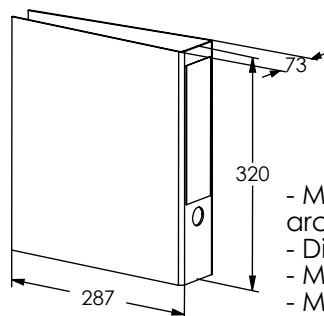
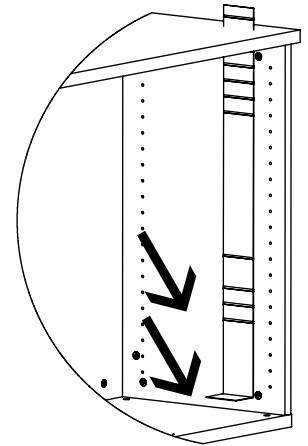

- Medidas carpesano o archivadores (A-Z)
- Dimensionis for A-Z binders
- Mesures du classeur
- Masse der Mappen (A-Z)

OH SYSTEMS 2.77.051.476.002

MOBEL LINEA
 MUEBLES OFICINA

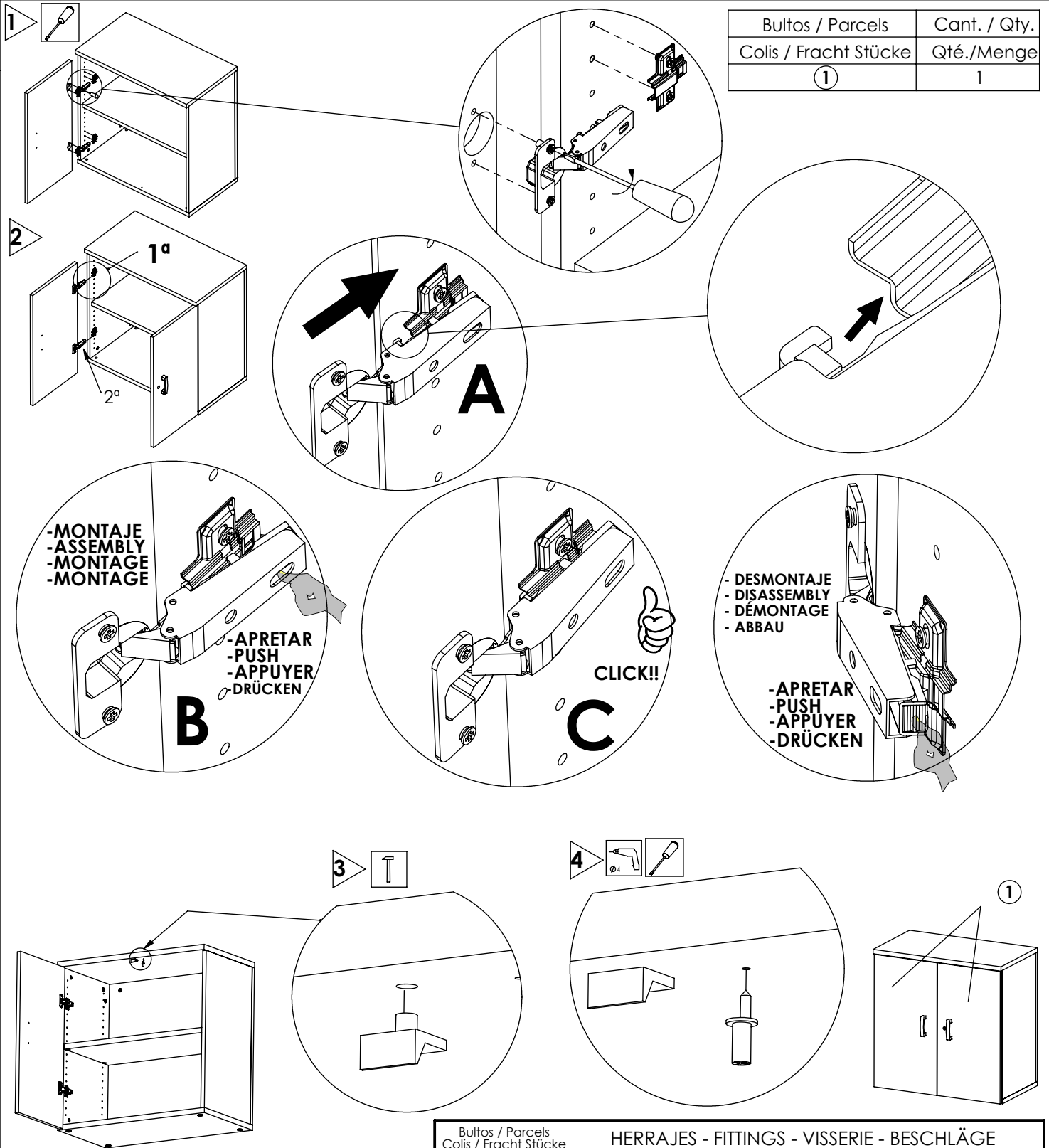
 MONTAJE BISAGRA A ARMARIO Y COLOCACION PUERTAS - 19 MM. BACK PANEL CABINET ASSEMBLY
 MONTAGE CHARNIERE ET PORTES - MONTAGE SCHARNIERE UND FLÜGELTÜREN

Ref. 1.08.365.129.000

Ref. 2.77.010.028.000

Ref. 2.77.011.418.000

Ref. 2.77.012.012.000

Ref. 2.77.012.014.000

Ref. 2.77.012.018.000

Ref. 2.77.012.019.000

Ref. 2.77.037.046.000

①

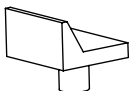

1



2

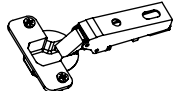

4



4



4

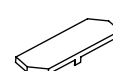

4

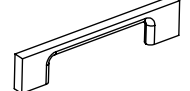

2